

Weld Fittings



www.panamengineers.com

Introduction

PANAM has emerged as renowned name in Global market for 'Instrumentation Fittings & Valves'. Since its inception in 1998 to present day, **PANAM** has added new product every year and has broadened its product portfolio and its clientele base by supplying to potential customers worldwide. Key core values like Timely Delivery, Quality Consistency, Product Improvisation and after sales service has been instrumental in the phase wise evolution of company. Continuous improvement is the key to success, Customer feedback are taken with positive attitude and product are constantly groomed to a new quality and performance level to cope up with the competition. Our products are known for providing high-quality, high-reliability, low-cost options for the oil and gas industry. Over the year, the company has evolved from a product based company to a complete system solution provider. Over the coming years the entity of the company will attain state of the art operational efficiency for maintaining a competitive edge, with the advent increase in the utilization of its products in oil, gas and power sector.

PANAM is having state of the art manufacturing facility span over an area of 65,000 sqft with a fleet of CNC machines, VMC machines, Semi-Automatic Lathe machines, High pressure test bench with SCADA control, Configuration centre for Transmitters and dedicated R&D Team.

PANAM is manufacturing a wide range of Weld Fittings and Instrumentation products in different sizes and materials like Stainless steel & Other Alloys (e.g. Monel, Hastalloy, Duplex, Super Duplex etc. as per the customer's requirements). **PANAM** Weld Fittings are designed to provide permanent weld connection in pressure impulse, system vibration and temperature cycling. Tube Socket end design meets and exceeds the requirements of ASME B16.11 for ease of tube socket welding. **PANAM** offers its products in various end connections like NPT, BSPP, BSPT, ISO Tapered, ISO Parallel, Tube & Pipe Socket Welded Ends, etc.

PANAM meets and even exceeds the requirements of ASME and MSS Series Standards. All materials are supplied in compliance with ASTM Specifications and verified by NABL approved third party laboratories.

PANAM Weld Fittings are also available in compliance with NACE MR0175 / ISO 15156 & NACE MR0103 / ISO 17495-1. with Heat Code Traceability.

Contents

**Features, Material, Threads,
Installation Instructions &
Welding Method Arc Policy**

01

**300 Series Stainless Steel, Carbide
Precipitation, Design Specifications &
Elevated Temperature Factors**

02

**Working Pressure,
Working Temperature &
Ordering Information**

03

Male Connector

Tube Socket Weld (Fractional) X
Male Pipe Threads (NPT)



04

Male Connector

Tube Socket Weld (Metric) X
Male Pipe Threads (NPT)



05

Female Connector

Tube Socket Weld (Fractional) X
Female Pipe Threads (NPT)



06

Female Connector

Tube Socket Weld (Metric) X
Female Pipe Threads (NPT)



07

Male Elbow

Tube Socket Weld (Fractional) X
Male Pipe Threads (NPT)



07

Female Elbow

Tube Socket Weld (Fractional) X
Female Pipe Threads (NPT)



08

Male Run Tee

Tube Socket Weld (Fractional) X
Male Pipe Threads (NPT)



09

Male Branch Tee

Tube Socket Weld (Fractional) X
Male Pipe Threads (NPT)



10

Union Elbow

Tube Socket Weld (Fractional)



11

Union Elbow

Tube Socket Weld (Metric)



11

Union

Tube Socket Weld (Fractional)



12

Union

Tube Socket Weld (Metric)



12

Union Tee

Tube Socket Weld (Fractional)



13

Union Tee

Tube Socket Weld (Metric)



13

Union Cross

Tube Socket Weld (Fractional)



14

Union Cross

Tube Socket Weld (Metric)



14

Reducing Union

Tube Socket Weld (Fractional)



15

Reducing Union

Tube Socket Weld (Metric)



15

Reducing Union

Tube Socket Weld (Fractional) X
Tube Socket Weld (Metric)



16

Union 45° Elbow

Tube Socket Weld (Fractional)



16

Union 45° Elbow

Tube Socket Weld (Metric)



17

Male Connector

Pipe Socket Weld X
Male Pipe Threads (NPT)



17

Female Connector

Pipe Socket Weld X
Female Pipe Threads (NPT)

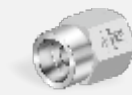

18

Union

Pipe Socket Weld



18

Male Connector

Tube Butt Weld (Fractional) X
Male Pipe Threads (NPT)



19

Male Connector

Tube Butt Weld (Metric) X
Male Pipe Threads (NPT)



19

Female Connector

Tube Butt Weld (Fractional) X
Female Pipe Threads (NPT)



20

Contents

Female Connector
Tube Butt Weld (Metric) X
Female Pipe Threads (NPT)



20

Reducing Union
Tube Butt Weld (Fractional)



21

Reducing Union
Tube Butt Weld (Metric)



21

Union Elbow
Tube Butt Weld (Fractional)



22

Union Elbow
Tube Butt Weld (Metric)



22

Union Tee
Tube Butt weld (Fractional)



23

Union Tee
Tube Butt Weld (Metric)



23

Union Cross
Tube Butt Weld (Fractional)



24

Union Cross
Tube Butt Weld (Metric)



24

Male Connector
Pipe Butt Weld X
Male Pipe Threads (NPT)



25

Female Connector
Pipe Butt Weld X
Male Pipe Threads (NPT)



25

Weld Adapter
Tube Socket Weld (Fractional) X
Pipe Butt Weld



26

Adaptor
Tube Socket Weld (Fractional) X
Pipe Butt Weld



27

Pipe to Tube Weld
Female ISO Parallel Threads X
Tube Butt Weld (Metric)



28

Pipe to Tube Butt Weld
Female Metric Pipe Threads X
Tube Butt Weld (Metric)



29

Male Pipe to Tube Butt Weld
Male NPT Pipe X
Tube Butt Weld (Metric)



30

Features

- Size Ranges from 1/8" to 2" in fractional series & 6 mm to 38 mm in metric series.
- 316 Stainless Steel is standard material. Other materials are available upon request.
- Straight fittings are manufactured from bar stock & Forged fittings are manufactured from forgings.
- Quality machining of all ports ensures consistent Welding.
- For smooth flow path, elbows are designed with radius junction.
- All Fittings are marked with Size, Material and Heat code for easy source tracing.
- All threads are capped for protection and properly packaged.
- All NPT pipe threads meet the requirements of ASME/ANSI B1.20.1.
- Working pressure meets the requirements of ANSI/ASME B31.3 at ambient temperature.

Material

Material	Bar Stock	Forging	Tubing	
			Fractional	Metric
Grade SS 316	ASTM A276, ASTM A479, ASME SA276, ASME SA479	ASTM A182 ASME SA182	ASTM A213 (Seamless). ASTM A249 (Welded). ASTM A269 (Seamless & Welded).	EN ISO 1127
Grade SS 316L	ASTM A276, ASTM A479, ASME SA276, ASME SA479	ASTM A182 ASME SA182	ASTM A213 (Seamless). ASTM A249 (Welded). ASTM A269 (Seamless & Welded).	EN ISO 1127

Threads

Threads	Specification
NPT Threads	ASME B1.20.1
BSPT / ISO Tapered Threads	ISO 7-1, BS 21, JIS B0203, EN 10226-1, DIN 2999
BSPT / ISO Parallel Threads	ISO 228-1, BS 2779, JIS B0202

NOTE: Standard **PANAM** Weld Fittings are supplied with American National Standard Pipe Taper Threads (NPT) as per ASME B1.20.1. The BSPT/ISO Tapered & BSPP/ISO Parallel Threads are available upon request.

Installation Instructions

To ensure leak proof tight seal, recommends use of pipe thread sealant on all NPT threads. The most effective sealing method is the use of Teflon tape, Tape should be used on male NPT tapered threads. Clean both male and female tapered threads, wrap tape in direction of male tapered, cut off excess tape.

Welding Methods Arc Polarity

When welding **PANAM** Weld Fittings, best results will be obtained by the following arc polarities:

- **TIG** – Direct Current, straight polarity.
- **MIG** – Direct Current, reverse polarity.
- **STICK** – Polarity dependent on rod used

300 Series Stainless Steels

May be welded by the TIG, MIG, or stick arc-weld process. TIG welding is recommended as being best for welding **PANAM** Weld Fittings systems because it allows better operator control of heat penetration and filler material deposition.

Stick arc welding is not recommended in many cases because of the likelihood of excessive burn-through and improper root penetration. In all cases where stick welding is used, it is recommended that backing gas be used.

MIG welding gives the same characteristics as stick electrode welding with faster deposition of the filler material. As this process runs "hotter" than the stick process, the use of a backing gas is mandatory. It should be noted that in welding the relatively small fitting sizes found in the **PANAM** Weld Fittings line, filler deposition rate economies are not a factor and therefore the MIG method is not commonly applied.

Carbide Precipitation

When unstabilized stainless steels are heated to 800°–1500°F during welding, the chromium in the steel combines with the carbon to form chrome carbides which tend to form along the grain boundaries of the metal (carbide precipitation). This lowers the dissolved chromium content in these areas and thus lowers their corrosion resistance, making them vulnerable to intergranular corrosion. Carbide precipitation is reduced by holding the carbon content of the material to a very low value. This limits the amount of carbon available to combine with the chromium. The L series extra low carbon stainless steels are often used for this purpose, but their use reduces system design stress by approximately 15%.

Weld Fittings in 316 series with carbon content in the low range of 0.04 to 0.07 percent results in a welded fitting with good corrosion resistance and a high strength factor. **PANAM** Weld fittings in stainless steel material supplied in the solution-treated condition are capable of passing ASTM A-262 Tests for Detecting Susceptibility to Intergranular Corrosion.

Design Specifications

The **PANAM** Weld Fitting has been designed and tested in accordance with ANSI B16.11, which covers "Forged Steel Fittings Socket Welded and Threaded." Our design parallels the Schedule 80, 3000-pound fitting pressure class, and is compatible with O.D. tube wall thickness meeting the related (3000-psi pipe class) pressure requirements. Strong, full section forgings are used for all "shape" fittings.

Elevated Temperature Factors

To determine elevated-temperature pressure ratings in accordance with B31.3 and B31.1, multiply the pressure ratings provided in the ordering number tables on the pages that follow by the factors in the table at right.

Temperature °F (°C)	Elevated Temperature Factors	
	SS 316	SS 316L
-20 (-28) to 100 (37)	1.00	1.00
200 (93)	1.00	0.83
400 (204)	0.96	0.77
600 (315)	0.84	0.67
800 (426)	0.79	0.62
1000 (537)	0.76	0.56

Example:

A 1/4 in. SS316 Tube Socket Weld union has a pressure rating of 9600 psig (660 bar), as shown in the table below in Dimensions section. To obtain the pressure rating at 400°F (204°C), multiply 9600 psig (660 bar) by 0.96:

$$9600 \text{ psig (660 bar)} \times 0.96 = 9216 \text{ psig (635 bar)}$$

Working Pressure

Catalogue pressure ratings shown are for temperatures from –20 to 100°F (–28 to 37°C), which are based on an allowable stress value of 20 000 psi (1378 bar) in accordance with ASME B31.3 for 316 stainless steel. To determine working pressures in accordance with ANSI/ASME B31.1, multiply catalogue working pressures shown by 0.94.

Use the allowable working pressure at ambient temperature to multiply the elevated temperature factors to get the working pressure at elevated temperature.

Working Temperature

Material	Minimum Working Temperature	Maximum Working Temperature
SS 316	-325°F (-198°C)	1000°F (538°C)
SS 316L	-325°F (-198°C)	850°F (454°C)

Consult ASME Boiler and Pressure Vessel Code, ASME B31.1, ASME B31.3, or other applicable codes for information on weld setup, technique, and additional considerations for welded systems. The choice of fitting, pipe, and tubing material being welded is critical. Using the same materials will ensure the same coefficients of expansion and will reduce the possibility of poor welds, out-of-roundness, or dimensional changes that are detrimental to a good weld.

Ordering Information

PANAM **P - MC - 4TSW - 4N - SS**

Fitting Type		P1 Size		P1 Size		P1 Type		P2, P3, and P4	Material	
MC	Male Connector	1	1/16	M6	6mm	N	NPT Threads	Specify as per P Type and P Size	SS	316 SS
FC	Female Connector	2	1/8	M8	8mm	R	BSPT / ISO Tapered Threads		SSL	316L SS
ME	Male Elbow	3	3/16	M10	10mm	G	BSPP / ISO Parallel Threads			
FE	Female Elbow	4	1/4	M12	12mm	M	Metric Threads			
MRT	Male Run Tee	5	5/16	M14	14mm	PBW	Pipe Buttweld			
MBT	Male Branch Tee	6	3/8	M16	16mm	TSW	Tube Socket Weld			
UE	Union Elbow	8	1/2	M18	18mm	TBW	Tube Buttweld			
U	Union	10	5/8	M20	20mm	PSW	Pipe Socket Weld			
UT	Union Tee	12	3/4	M22	22mm					
UC	Union Cross	14	7/8	M24	24mm					
RU	Reducing Union	16	1	M25	25mm					
WA	Weld Adaptors	20	1-1/4	M28	28mm					
		24	1-1/2	M32	32mm					
		32	2	M38	38mm					

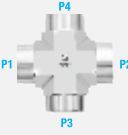

P1, P2, P3 & P4 Shall be described in the following orders. For tees, the run (1 to 2) shall precede the branch (3). For Crosses, the run (1 to 2) shall precede the branch (3 to 4)

Male Connector - Tube Socket Weld (Fractional) X Male Pipe Threads (NPT)

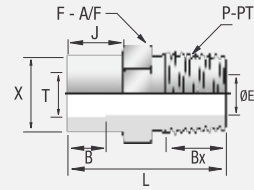

Part No	T Tube O.D. (in.)	P Pipe Size, NPT	E Small Bore	B	L	J	Bx	F (in)	X	Work. Press. (psig)
PMC-2TSW-2N-SS	1/8	1/8	2.3	4.0	23.9	8.6	9.7	7/16	9.5	9100
PMC-2TSW-2N-SS	1/8	1/4	2.3	4.0	29.0	8.6	14.2	9/16	9.5	7500
PMC-3TSW-2N-SS	3/16	1/8	3.6	5.2	24.9	9.9	9.7	1/2	11.1	9100
PMC-3TSW-4N-SS	3/16	1/4	3.6	5.2	30.2	9.9	14.2	9/16	11.1	7500
PMC-4TSW-2N-SS	1/4	1/8	4.8	6.4	26.7	11.2	9.7	9/16	12.7	9100
PMC-4TSW-4N-SS	1/4	1/4	4.8	6.4	31.2	11.2	14.2	9/16	12.7	7500
PMC-4TSW-8N-SS	1/4	1/2	4.8	6.4	38.1	11.2	19.1	7/8	12.7	6600
PMC-5TSW-2N-SS	5/16	1/8	6.4	8.0	28.7	12.7	9.7	5/8	15.1	9100
PMC-6TSW-2N-SS	3/8	1/8	4.8	8.7	29.5	13.5	9.7	11/16	15.9	8100
PMC-6TSW-4N-SS	3/8	1/4	7.1	8.7	34.0	13.5	14.2	11/16	15.9	7500
PMC-6TSW-6N-SS	3/8	3/8	7.9	8.7	34.0	13.5	14.2	11/16	15.9	7200
PMC-6TSW-8N-SS	3/8	1/2	7.9	8.7	40.4	13.5	19.1	7/8	15.9	6600
PMC-6TSW-12N-SS	3/8	3/4	7.9	8.7	42.2	13.5	19.1	1-1/16	15.9	6400
PMC-8TSW-2N-SS	1/2	1/8	4.8	10.3	31.8	15.0	9.7	13/16	19.8	7300
PMC-8TSW-4N-SS	1/2	1/4	7.1	10.3	36.6	15.0	14.2	13/16	19.8	7300
PMC-8TSW-6N-SS	1/2	3/8	10.4	10.3	36.6	15.0	14.2	13/16	19.8	7200
PMC-8TSW-8N-SS	1/2	1/2	11.2	10.3	42.2	15.0	19.1	7/8	19.8	6600
PMC-8TSW-12N-SS	1/2	3/4	11.2	10.3	43.7	15.0	19.1	1-1/16	19.8	6400
PMC-10TSW-4N-SS	5/8	1/4	7.1	11.9	39.6	16.8	14.2	1	23.8	6600
PMC-10TSW-6N-SS	5/8	3/8	10.4	11.9	39.6	16.8	14.2	1	23.8	6600
PMC-10TSW-8N-SS	5/8	1/2	12.7	11.9	44.5	16.8	19.1	1	23.8	6600
PMC-10TSW-12N-SS	5/8	3/4	12.7	11.9	45.2	16.8	19.1	1-1/16	23.8	6400
PMC-12TSW-8N-SS	3/4	1/2	12.7	12.7	46.0	17.5	19.1	1-1/8	27.8	6000
PMC-12TSW-12N-SS	3/4	3/4	16.8	12.7	46.0	17.5	19.1	1-1/8	27.8	6000
PMC-12TSW-16N-SS	3/4	1	16.8	12.7	53.1	17.5	23.9	1-3/8	27.8	4600
PMC-14TSW-12N-SS	7/8	3/4	18.3	12.7	48.5	17.5	19.1	1-3/8	33.3	5700
PMC-16TSW-8N-SS	1	1/2	12.7	14.3	51.3	19.1	19.1	1-5/8	36.5	4900
PMC-16TSW-12N-SS	1	3/4	18.3	14.3	51.3	19.1	19.1	1-5/8	36.5	4900
PMC-16TSW-16N-SS	1	1	23.1	14.3	55.9	19.1	23.9	1-5/8	36.5	4600
PMC-20TSW-12N-SS	1-1/4	3/4	18.3	15.9	54.4	20.6	19.1	1-7/8	44.5	4600
PMC-20TSW-16N-SS	1-1/4	1	23.9	15.9	59.2	20.6	23.9	1-7/8	44.5	4600
PMC-20TSW-20N-SS	1-1/4	1-1/4	26.9	15.9	59.9	20.6	24.6	1-7/8	44.5	3500
PMC-20TSW-24N-SS	1-1/4	1-1/2	26.9	15.9	61.5	20.6	25.4	2	44.5	2900
PMC-24TSW-20N-SS	1-1/2	1-1/4	31.8	17.0	63.2	21.8	24.6	2-1/8	50.8	3500
PMC-24TSW-24N-SS	1-1/2	1-1/2	33.3	17.0	64.0	21.8	25.4	2-1/8	50.8	2900
PMC-32TSW-32N-SS	2	2	46.0	19.8	75.4	24.6	26.2	2-1/8	66.7	2600

Male Connector - Tube Socket Weld (Metric) X Male Pipe Threads (NPT)

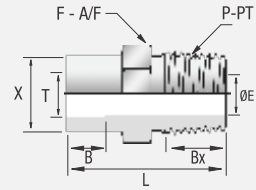

Part No	T Tube O.D. (mm)	P Pipe Size, NPT	E Small Bore	B	L	Bx	F	X	Work. Press. (psig)
PMC-M06TSW-4N-SS	6	1/4	4.8	7.1	29.2	14.2	14.0	12.0	8000
PMC-M12TSW-8N-SS	12	1/2	9.5	9.7	38.9	19.1	22.0	20.2	6820
PMC-M14TSW-4N-SS	14	1/4	7.1	10.0	33.3	14.2	24.0	23.8	6930
PMC-M14TSW-6N-SS	14	3/8	9.6	10.0	35.0	14.2	24.0	23.8	6930
PMC-M14TSW-8N-SS	14	1/2	10.4	10.0	40.0	19.1	24.0	23.8	6930
PMC-M16TSW-4N-SS	16	1/4	7.1	10.4	35.0	14.2	24.0	23.8	6190
PMC-M16TSW-8N-SS	16	1/2	11.9	10.4	40.0	19.1	24.0	23.8	6190
PMC-M18TSW-4N-SS	18	1/4	7.1	11.2	40.1	14.2	27.0	26.0	6050
PMC-M28TSW-12N-SS	28	3/4	15.7	20.0	55.5	19.1	41.0	40.0	5040
PMC-M38TSW-20N-SS	38	1-1/4	28.6	22.0	68.3	23.9	52.0	50.8	5000

Female Connector - Tube Socket Weld (Fractional) X Female Pipe Threads (NPT)

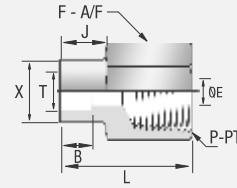

Part No	T Tube O.D. (in.)	P Pipe Size, NPT	E Small Bore	B	L	J	F (in)	X	Work. Press. (psig)
PFC-2TSW-2N-SS	1/8	1/8	2.3	4.0	24.1	8.6	9/16	9.5	6400
PFC-3TSW-3N-SS	3/16	3/16	3.6	5.2	24.9	9.9	9/16	11.1	6400
PFC-4TSW-2N-SS	1/4	1/8	4.8	6.4	25.7	11.2	9/16	12.7	6400
PFC-4TSW-4N-SS	1/4	1/4	4.8	6.4	32.0	11.2	3/4	12.7	6600
PFC-4TSW-12N-SS	1/4	3/4	4.8	6.4	45.7	11.2	1-1/4	12.7	4300
PFC-5TSW-2N-SS	5/16	1/8	6.4	8.0	27.2	12.7	5/8	15.1	6400
PFC-6TSW-2N-SS	3/8	1/8	7.9	8.7	28.2	13.5	11/16	15.9	6400
PFC-6TSW-4N-SS	3/8	1/4	7.9	8.7	33.5	13.5	3/4	15.9	6600
PFC-6TSW-6N-SS	3/8	3/8	7.9	8.7	36.1	13.5	7/8	15.9	5300
PFC-6TSW-8N-SS	3/8	1/2	7.9	8.7	42.4	13.5	1-1/16	15.9	5200
PFC-6TSW-12N-SS	3/8	3/4	7.9	8.7	47.2	13.5	1-1/4	15.9	4300
PFC-6TSW-16N-SS	3/8	1	7.9	8.7	58.4	13.5	1-5/8	15.9	4500
PFC-8TSW-2N-SS	1/2	1/8	8.6	10.3	29.7	15.0	13/16	19.8	6400
PFC-8TSW-4N-SS	1/2	1/4	11.2	10.3	34.5	15.0	13/16	19.8	6600
PFC-8TSW-6N-SS	1/2	3/8	11.2	10.3	36.6	15.0	7/8	19.8	5300
PFC-8TSW-8N-SS	1/2	1/2	11.2	10.3	42.9	15.0	1-1/16	19.8	5200
PFC-10TSW-6N-SS	5/8	3/8	12.7	11.9	38.6	16.8	1-1/16	23.8	5300
PFC-10TSW-8N-SS	5/8	1/2	12.7	11.9	43.4	16.8	1-1/16	23.8	5200
PFC-10TSW-16N-SS	5/8	1	12.7	11.9	59.2	16.8	1-5/8	23.8	4500
PFC-12TSW-8N-SS	3/4	1/2	16.8	12.7	43.7	17.5	1-1/8	27.8	5200
PFC-12TSW-12N-SS	3/4	3/4	16.8	12.7	47.8	17.5	1-1/4	27.8	4300
PFC-14TSW-12N-SS	7/8	3/4	19.8	12.7	47.2	17.5	1-3/8	33.3	4300
PFC-16TSW-8N-SS	1	1/2	18.3	14.3	47.0	19.1	1-5/8	36.5	4900
PFC-16TSW-12N-SS	1	3/4	23.4	14.3	50.0	19.1	1-5/8	36.5	4300
PFC-16TSW-16N-SS	1	1	23.4	14.3	57.9	19.1	1-5/8	36.5	4500
PFC-20TSW-20N-SS	1-1/4	1-1/4	26.9	15.9	60.7	20.6	2	44.5	3500

Female Connector - Tube Socket Weld (Metric) X Female Pipe Threads (NPT)

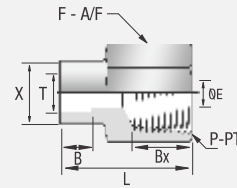

Part No	T Tube O.D. (mm)	P Pipe Size, NPT	E Small Bore	B	Bx	L	F	X	Work. Press. (psig)
PFC-M08TSW-4N-SS	8	1/4	4.8	7.9	15.0	27.0	19.0	14.3	6600
PFC-M10TSW-4N-SS	10	1/4	7.1	7.9	15.0	29.0	19.0	16.5	6600
PFC-M14TSW-4N-SS	14	1/4	9.5	10.0	15.0	32.0	24.0	23.8	6930
PFC-M28TSW-12N-SS	28	3/4	19.8	20.0	20.6	54.1	41.0	40.0	4600

Male Elbow - Tube Socket Weld (Fractional) X Male Pipe Threads (NPT)

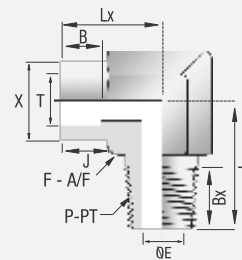

Part No	T Tube O.D. (in.)	P Pipe Size, NPT	E Small Bore	B	L	J	Lx	Bx	F (in)	X	Work. Press. (psig)
PME-2TSW-2N-SS	1/8	1/8	2.3	4.0	18.8	8.6	17.8	9.7	1/2	9.5	9100
PME-2TSW-4N-SS	1/8	1/4	2.3	4.0	23.6	8.6	17.8	14.2	1/2	9.5	7500
PME-3TSW-2N-SS	3/16	1/8	3.6	5.2	18.8	9.9	19.1	9.7	1/2	11.1	9100
PME-4TSW-2N-SS	1/4	1/8	4.8	6.4	20.1	11.2	21.3	9.7	9/16	12.7	9100
PME-4TSW-4N-SS	1/4	1/4	4.8	6.4	24.6	11.2	21.3	14.2	9/16	12.7	7500
PMC-5TSW-2N-SS	5/16	1/8	6.4	8.0	20.1	12.7	22.9	9.7	9/16	15.1	9100
PMC-6TSW-4N-SS	3/8	1/4	7.9	8.7	28.4	13.5	27.4	14.2	13/16	15.9	7500
PMC-6TSW-6N-SS	3/8	3/8	7.9	8.7	28.4	13.5	27.4	14.2	13/16	15.9	7200
PMC-6TSW-8N-SS	3/8	1/2	7.9	8.7	33.3	13.5	27.4	19.1	13/16	15.9	5800
PMC-8TSW-4N-SS	1/2	1/4	11.2	10.3	28.4	15.0	29.0	14.2	7/8	19.8	7300
PMC-8TSW-6N-SS	1/2	3/8	11.2	10.3	28.4	15.0	29.0	14.2	7/8	19.8	7200
PMC-8TSW-8N-SS	1/2	1/2	11.2	10.3	33.3	15.0	29.0	19.1	13/16	19.8	5800
PMC-10TSW-8N-SS	5/8	1/2	12.7	11.9	37.1	16.8	34.5	19.1	1-1/16	23.9	5800
PMC-12TSW-4N-SS	3/4	1/4	16.8	12.7	32.3	17.5	35.3	14.2	1-1/16	27.7	6000
PMC-12TSW-8N-SS	3/4	1/2	16.8	12.7	37.1	17.5	35.3	19.1	1-1/16	27.7	5800
PMC-12TSW-12N-SS	3/4	3/4	16.8	12.7	37.1	17.5	35.3	19.1	1-1/16	27.7	6000
PMC-16TSW-12N-SS	1	3/4	18.3	14.3	46.7	19.1	16.7	19.1	1-5/8	36.6	4900
PMC-16TSW-16N-SS	1	1	23.1	14.3	51.6	19.1	46.7	23.9	1-5/8	36.6	4400
PMC-20TSW-20N-SS	1-1/4	1-1/4	26.9	15.9	57.7	20.6	53.3	24.6	1-7/8	44.5	3500
PMC-24TSW-24N-SS	1-1/2	1-1/2	33.3	17.0	68.3	21.8	64.5	25.4	2-1/2	50.8	2900

Female Elbow - Tube Socket Weld (Fractional) X Female Pipe Threads (NPT)

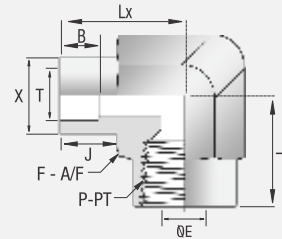
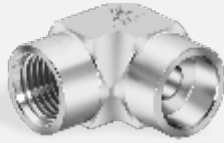

Part No	T Tube O.D. (in.)	P Pipe Size, NPT	E Small Bore	B	L	J	Lx	F (in)	X	Work. Press. (psig)
PFE-2TSW-2N-SS	1/8	1/8	2.3	4.0	19.1	8.6	17.8	1/2	9.5	5500
PFE-3TSW-2N-SS	3/16	1/8	3.6	5.2	19.1	9.9	19.1	1/2	11.1	5500
PFE-4TSW-2N-SS	1/4	1/8	4.8	6.4	19.1	11.2	21.3	9/16	12.7	5500
PFE-4TSW-4N-SS	1/4	1/4	4.8	6.4	22.4	11.2	23.1	11/16	12.7	5600
PFE-5TSW-2N-SS	5/16	1/8	6.4	8.0	19.1	12.7	22.9	9/16	15.1	5500
PFE-6TSW-4N-SS	3/8	1/4	7.9	8.7	22.4	13.5	25.4	11/16	15.9	5600
PFE-6TSW-6N-SS	3/8	3/8	7.9	8.7	22.4	13.5	27.4	13/16	15.9	5000
PFE-6TSW-8N-SS	3/8	1/2	7.9	8.7	28.4	13.5	30.2	1	15.9	4500
PFE-8TSW-4N-SS	1/2	1/4	11.2	10.3	22.4	15.0	29.0	7/8	19.8	5600
PFE-8TSW-6N-SS	1/2	3/8	11.2	10.3	22.4	15.0	29.0	7/8	19.8	5000
PFE-8TSW-8N-SS	1/2	1/2	11.2	10.3	28.4	15.0	32.8	1-1/16	19.8	4500
PFE-10TSW-8N-SS	5/8	1/2	12.7	11.9	28.4	16.8	34.5	1-1/16	23.8	4500
PFE-12TSW-4N-SS	3/4	1/4	11.2	12.7	28.4	17.5	35.3	1-1/16	27.8	5600
PFE-12TSW-12N-SS	3/4	3/4	16.8	12.7	31.8	17.5	40.1	1-5/16	27.8	3500
PFE-14TSW-12N-SS	7/8	3/4	19.8	12.7	31.8	17.5	40.1	1-3/8	33.3	3500
PFE-16TSW-6N-SS	1	3/8	14.7	14.3	44.5	19.1	46.7	1-5/8	36.5	4900
PFE-16TSW-16N-SS	1	1	23.1	14.3	38.1	19.1	46.7	1-5/8	36.5	3900
PFE-20TSW-20N-SS	1-1/4	1-1/4	26.9	15.9	47.8	20.6	53.3	1-7/8	44.5	3100
PFE-24TSW-16N-SS	1-1/2	1	29.5	17.0	52.8	21.8	64.5	2-1/2	50.8	3700
PFE-24TSW-24N-SS	1-1/2	1-1/2	33.3	17.0	54.1	21.8	64.5	2-1/2	50.8	2500

Male Run Tee - Tube Socket Weld (Fractional) X Male Pipe Threads (NPT)

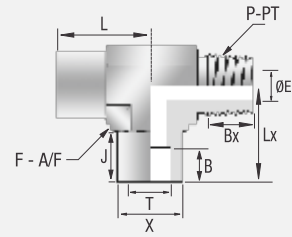
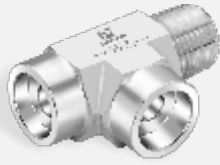

Part No	T Tube O.D. (in.)	P Pipe Size, NPT	E Small Bore	L	Lx	X	F (in)	B	J	Bx	Work. Press. (psig)
PMRT-2TSW-2N-SS	1/8	1/8	2.3	17.8	18.8	9.5	1/2	4.0	8.6	9.7	9100
PMRT-3TSW-2N-SS	3/16	1/8	3.6	19.1	18.8	11.1	1/2	5.2	9.9	9.7	9100
PMRT-4TSW-2N-SS	1/4	1/8	4.8	21.3	20.1	12.7	9/16	6.4	11.2	9.7	9100
PMRT-5TSW-2N-SS	5/16	1/8	4.8	22.9	20.1	15.1	9/16	8.0	12.7	9.7	9100
PMRT-6TSW-4N-SS	3/8	1/4	7.1	27.4	28.4	15.9	13/16	8.7	13.5	14.2	7500
PMRT-8TSW-6N-SS	1/2	3/8	10.4	29.0	28.4	19.8	7/8	10.3	15.0	14.2	7200
PMRT-10TSW-8N-SS	5/8	1/2	12.7	34.5	37.1	23.8	1-1/16	11.9	16.8	19.1	5800
PMRT-12TSW-12N-SS	3/4	3/4	16.7	35.3	37.1	27.8	1-1/16	12.7	17.5	19.1	6000
PMRT-14TSW-12N-SS	7/8	3/4	18.3	40.1	41.9	33.3	1-3/8	12.7	17.5	19.1	5700
PMRT-16TSW-16N-SS	1	1	23.0	46.7	51.6	36.5	1-5/8	14.3	19.1	23.9	4400
PMRT-20TSW-20-SS	1-1/4	1-1/4	27.0	53.3	57.7	44.5	1-7/8	15.9	20.6	24.6	3500
PMRT-24TSW-24N-SS	1-1/2	1-1/2	33.4	64.5	68.6	50.8	2-1/2	17.0	21.8	25.4	2900
PMRT-32TSW-32N-SS	2	2	46.1	70.6	72.4	66.7	2-13/16	19.8	24.6	26.2	2600

Male Branch Tee - Tube Socket Weld (Fractional) X Male Pipe Threads (NPT)

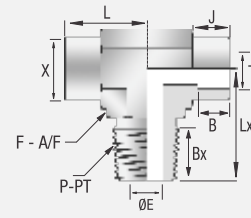
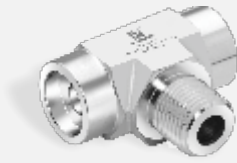

Part No	T Tube O.D. (in.)	P Pipe Size, NPT	E Small Bore	L	Lx	X	F (in)	B	J	Bx	Work. Press. (psig)
PMBT-2TSW-2N-SS	1/8	1/8	2.3	17.8	18.8	9.5	1/2	4.0	8.6	9.7	9100
PMBT-3TSW-2N-SS	3/16	1/8	3.6	18.8	19.1	11.1	1/2	5.2	9.9	9.7	9100
PMBT-4TSW-2N-SS	1/4	1/8	4.8	21.3	20.1	12.7	9/16	6.4	11.2	9.7	9100
PMBT-5TSW-2N-SS	5/16	1/8	4.8	22.9	20.1	15.1	9/16	8.0	12.7	9.7	9100
PMBT-6TSW-4N-SS	3/8	1/4	7.1	27.4	28.4	15.9	3/16	8.7	13.5	14.2	7500
PMBT-8TSW-6N-SS	1/2	3/8	10.4	29.0	28.4	19.8	7/8	10.3	15.0	14.2	7200
PMBT-10TSW-8N-SS	5/8	1/2	12.7	34.5	37.1	23.8	1-1/16	11.9	16.8	19.1	5800
PMBT-12TSW-12N-SS	3/4	3/4	16.8	35.3	37.1	27.8	1-1/16	12.7	17.5	19.1	6000
PMBT-14TSW-12N-SS	7/8	3/4	18.3	40.1	41.9	33.3	1-3/8	12.7	17.5	19.1	5700
PMBT-16TSW-16N-SS	1	1	23.1	46.7	51.6	36.5	1-5/8	14.3	19.1	23.9	4400
PMBT-20TSW-20N-SS	1-1/4	1-1/4	26.9	53.3	57.7	44.5	1-7/8	15.9	20.6	24.6	3500
PMBT-24TSW-24N-SS	1-1/2	1-1/2	33.3	64.5	68.8	50.8	2-1/2	17.0	21.8	25.4	2900
PMBT-32TSW-32N-SS	2	2	46.0	70.6	72.4	66.7	2-3/16	19.8	24.6	26.2	2600

Union Elbow - Tube Socket Weld (Fractional)

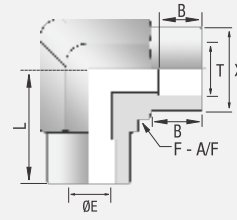

Part No	T Tube O.D. (in.)	E Small Bore	B	L	J	F (in)	X	Work. Press. (psig)
PUE-2TSW-SS	1/8	2.3	4.0	17.0	8.6	1/2	9.5	10200
PUE-3TSW-SS	3/16	3.6	5.2	19.2	9.9	1/2	11.1	9600
PUE-4TSW-SS	1/4	4.8	6.4	21.3	11.2	9/16	12.7	9600
PUE-5TSW-SS	5/16	6.4	8.0	22.9	12.7	9/16	15.1	9900
PUE-6TSW-SS	3/8	7.9	8.7	27.4	13.5	13/16	15.9	8100
PUE-8TSW-SS	1/2	11.2	10.3	29.0	15.0	7/8	19.8	7300
PUE-10TSW-SS	5/8	12.7	11.9	34.5	16.6	1-1/16	23.8	6600
PUE-12TSW-SS	3/4	16.8	12.7	35.3	17.5	1-1/16	27.8	6000
PUE-14TSW-SS	7/8	19.8	12.7	40.1	17.5	1-5/16	33.3	5700
PUE-16TSW-SS	1	23.1	14.3	46.7	19.1	1-5/8	36.5	4400
PUE-20TSW-SS	1-1/4	26.9	15.9	53.3	20.6	1-7/8	44.5	4600
PUE-24TSW-SS	1-1/2	33.3	17.0	64.5	21.8	2-1/2	50.8	3700
PUE-32TSW-SS	2	46.0	19.8	70.6	24.6	2-13/16	66.7	3300

Union Elbow - Tube Socket Weld (Metric)

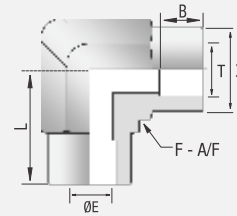

Part No	T Tube O.D. (mm)	E Small Bore	B	L	F	X	Work. Press. (psig)
PUE-M10TSW-SS	10	7.4	7.9	24.6	14.3	16.5	8100
PUE-M12TSW-SS	12	9.5	9.7	29.7	17.5	20.21	6820
PUE-M14TSW-SS	14	10.4	10.0	31.7	20.6	23.8	6930
PUE-M16TSW-SS	16	12.7	10.4	34.7	20.6	23.8	6190

Union - Tube Socket Weld (Fractional)

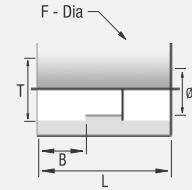

Part No	T Tube O.D. (in)	E Small Bore	B	L	F	Work. Press. (psig)
PU-2TSW-SS	1/8	2.3	4.0	17.5	9.5	10200
PU-3TSW-SS	3/16	3.6	5.2	19.8	11.1	9600
PU-4TSW-SS	1/4	4.8	6.4	22.4	12.7	9600
PU-5TSW-SS	5/16	6.4	8.0	25.4	15.1	9900
PU-6TSW-SS	3/8	7.9	8.7	26.9	15.9	8100
PU-8TSW-SS	1/2	11.2	10.2	30.2	19.8	7300
PU-10TSW-SS	5/8	12.7	11.9	33.3	23.8	6600
PU-12TSW-SS	3/4	16.8	12.7	35.1	27.8	6000
PU-14TSW-SS	7/8	19.8	12.7	35.1	33.3	5700
PU-16TSW-SS	1	23.1	14.3	38.1	36.6	4900
PU-20TSW-SS	1-1/4	26.9	15.9	41.3	44.5	4600
PU-24TSW-SS	1-1/2	33.3	17.0	46.7	50.8	3700
PU-32TSW-SS	2	46.0	19.8	54.1	66.7	3300

Union - Tube Socket Weld (Metric)

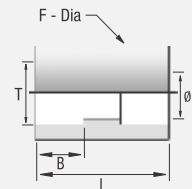

Part No	T Tube O.D. (mm)	E Small Bore	B	L	F	Work. Press. (psig)
PU-M08TSW-SS	08	7.4	7.9	22.4	14.3	8100
PU-M10TSW-SS	10	9.5	9.7	23.6	16.5	6820
PU-M12TSW-SS	12	10.4	10.0	26.9	20.2	6930
PU-M14TSW-SS	14	10.4	10.4	28.0	23.8	6190
PU-M16TSW-SS	16	12.7	10.4	30.2	23.8	6190
PU-M20TSW-SS	20	17.0	11.2	28.0	28.0	5510

Union Tee - Tube Socket Weld (Fractional)

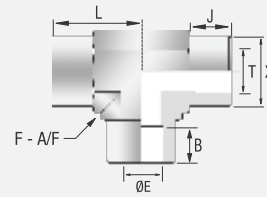
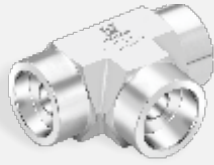

Part No	T Tube O.D. (in.)	E Small Bore	B	J	L	F (in)	X	Work. Press. (psig)
PUT-2TSW-SS	1/8	2.3	4.0	8.6	17.8	1/2	9.5	10200
PUT-3TSW-SS	3/16	3.6	5.2	9.9	19.1	1/2	11.1	9600
PUT-4TSW-SS	1/4	4.8	6.4	11.2	21.3	9/16	12.7	9600
PUT-5TSW-SS	5/16	6.4	8.0	12.7	22.9	9/16	15.1	9900
PUT-6TSW-SS	3/8	7.9	8.7	13.5	27.4	13/16	15.9	8100
PUT-8TSW-SS	1/2	11.2	10.3	15.0	29.0	7/8	19.8	7300
PUT-10TSW-SS	5/8	12.7	11.9	16.8	34.5	1-1/16	23.8	6600
PUT-12TSW-SS	3/4	16.8	12.7	17.5	35.3	1-1/16	27.8	6000
PUT-14TSW-SS	7/8	19.8	12.7	17.5	40.1	1-3/16	33.3	5700
PUT-16TSW-SS	1	23.1	14.3	19.1	46.7	1-5/8	36.6	4400
PUT-20TSW-SS	1-1/4	26.9	15.9	20.6	53.4	1-7/8	44.5	4600
PUT-24TSW-SS	1-1/2	33.3	17.0	21.8	64.5	2-1/2	50.8	3700
PUT-32TSW-SS	2	46.0	19.8	24.6	70.6	2-13/16	66.7	3300

Union Tee - Tube Socket Weld (Metric)

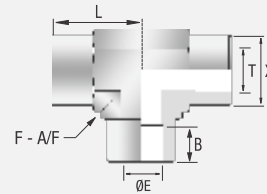
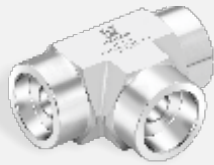

Part No	T Tube O.D. (mm)	E Small Bore	B	L	F	X	Work. Press. (psig)
PUT-M08TSW-SS	8	6.4	7.9	19.8	12.7	14.7	9790
PUT-M10TSW-SS	10	7.4	7.9	24.6	14.3	16.5	8100
PUT-M12TSW-SS	12	9.5	9.7	29.7	17.5	20.2	6820
PUT-M14TSW-SS	14	10.4	10.0	31.7	20.6	23.8	6930
PUT-M16TSW-SS	16	12.7	10.4	36.0	20.6	23.8	6190
PUT-M20TSW-SS	20	17.0	11.2	39.6	25.4	29.3	5510
PUT-M22TSW-SS	22	19.0	13.5	41.3	27.0	31.2	6850
PUT-M25TSW-SS	25	22.0	15.7	48.8	31.8	36.7	5450

Union Cross - Tube Socket Weld (Fractional)

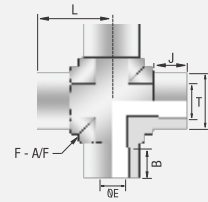

Part No	T Tube O.D. (in.)	E Small Bore	B	J	L	F (in)	X	Work. Press. (psig)
PUC-2TSW-SS	1/8	2.3	4.0	8.6	17.8	1/2	9.5	10200
PUC-3TSW-SS	3/16	3.6	5.2	9.9	19.1	1/2	11.1	9600
PUC-4TSW-SS	1/4	4.8	6.4	11.2	21.3	9/16	12.7	9600
PUC-5TSW-SS	5/16	6.4	8.0	12.7	22.9	9/16	15.1	9900
PUC-6TSW-SS	3/8	7.9	8.7	13.5	27.2	13/16	15.9	8100
PUC-8TSW-SS	1/2	11.2	10.3	15.0	29.0	7/8	19.8	7300
PUC-10TSW-SS	5/8	12.7	11.9	16.8	34.5	1-1/16	23.8	6600
PUC-12TSW-SS	3/4	16.8	12.7	17.5	35.3	1-1/16	27.8	6000
PUC-16TSW-SS	1	23.1	14.3	19.1	46.7	1-5/16	36.5	4400
PUC-20TSW-SS	1-1/4	26.9	15.9	20.6	53.3	1-7/8	44.5	4600
PUC-24TSW-SS	1-1/2	33.3	17.0	21.8	64.5	2-9/16	50.8	3700
PUC-32TSW-SS	2	46.0	19.8	24.6	70.6	2-9/16	66.7	3300

Union Cross - Tube Socket Weld (Metric)

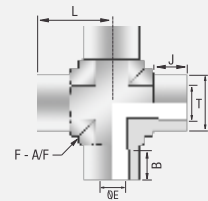

Part No	T Tube O.D. (mm)	E Small Bore	B	L	F	X	Work. Press. (psig)
PUC-M08TSW-SS	8	6.4	7.9	19.8	12.7	14.7	9790
PUC-M10TSW-SS	10	7.1	7.9	24.6	14.3	16.5	8100
PUC-M12TSW-SS	12	9.5	9.7	29.7	17.5	20.2	6820
PUC-M14TSW-SS	14	10.4	10.0	31.7	20.6	23.8	6930
PUC-M16TSW-SS	16	12.7	10.4	36.0	20.6	23.8	6190
PUC-M20TSW-SS	20	17.0	11.2	39.6	25.4	29.3	5510
PUC-M22TSW-SS	22	19.0	13.5	41.3	27.0	31.2	6850
PUC-M25TSW-SS	25	22.0	15.7	48.8	31.8	36.7	5450

Reducing Union - Tube Socket Weld (Fractional)

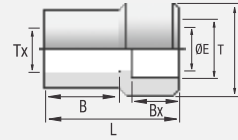

Part No	T Tube O.D. (in.)	Tx Tube O.D. (in.)	L	X	B	E	Bx	Work. Press. (psig)
PRU-06TSW-04TSW-SS	3/8	1/4	22.4	15.2	7.9	4.8	7.1	8100
PRU-08TSW-04TSW-SS	1/2	1/4	24.3	18.5	9.7	4.8	7.1	6600
PRU-08TSW-06TSW-SS	1/2	3/8	26.1	18.5	9.7	7.1	7.9	6600
PRU-12TSW-06TSW-SS	3/4	3/8	29.8	26.4	11.2	7.1	7.9	5900
PRU-12TSW-08TSW-SS	3/4	1/2	31.6	26.4	11.2	10.4	9.7	5900
PRU-16TSW-12TSW-SS	1	3/4	32.1	34.5	15.7	16.0	11.2	5600

Reducing Union - Tube Socket Weld (Metric)

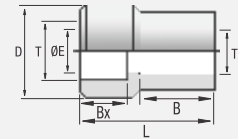

Part No	T Tube O.D. (mm.)	Tx Tube O.D. (mm.)	L	D	B	E	Bx	Work. Press. (psig)
PRU-M14TSW-M10TSW-SS	14	10	26.0	23.8	10.4	7.4	7.9	6930
PRU-M25TSW-M14TSW-SS	25	14	30.0	34.5	15.7	10.4	10.0	5450
PRU-M25TSW-M22TSW-SS	25	22	35.8	34.5	15.7	19.0	13.5	5450

Reducing Union - Tube Socket Weld (Fractional) X Tube Socket Weld (Metric)

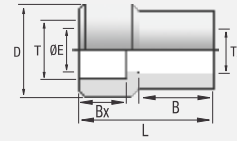

Part No	T Tube O.D. (mm)	Tx Tube O.D. (in.)	L	D	B	E	Bx	Work. Press. (psig)
PRU-M20TSW-12TSW-SS	20	3/4	28.0	27.0	11.2	15.7	11.2	5510
PRU-M28TSW-12TSW-SS	28	3/4	36.8	40.0	20.0	15.7	11.2	5040

Union 45° Elbow - Tube Socket Weld (Fractional)

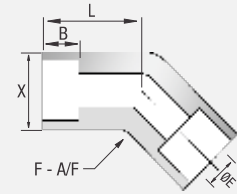
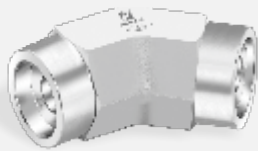

Part No	T Tube O.D. (in.)	L	X	B	F (in)	E	Work. Press. (psig)
PUE-A-2TSW-SS	1/8	13.5	9.5	4.0	7/16	2.3	10200
PUE-A-3TSW-SS	3/16	18.5	11.1	5.8	9/16	3.6	9600
PUE-A-4TSW-SS	1/4	21.3	12.7	6.4	9/16	4.8	9600
PUE-A-5TSW-SS	5/16	21.8	15.1	8.0	9/16	6.4	9900
PUE-A-6TSW-SS	3/8	27.4	15.9	8.7	7/8	7.9	8100
PUE-A-8TSW-SS	1/2	29.0	19.8	10.3	7/8	11.2	7300
PUE-A-10TSW-SS	5/8	34.0	23.8	11.9	1-1/16	12.7	6600
PUE-A-12TSW-SS	3/4	34.0	27.8	12.7	1-1/16	16.8	6000
PUE-A-16TSW-SS	1	41.4	36.5	14.3	1-5/8	23.1	4400
PUE-A-20TSW-SS	1-1/4	41.1	44.5	15.9	1-7/8	26.9	4600
PUE-A-24TSW-SS	1-1/4	42.4	50.8	17.0	2-1/2	33.3	3700
PUE-A-32TSW-SS	2	42.4	66.8	19.8	2-1/2	46.0	3300

Union 45° Elbow - Tube Socket Weld (Metric)

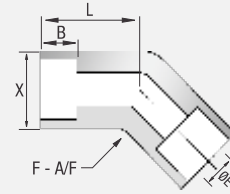
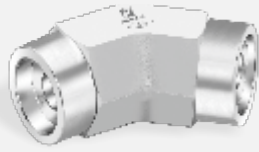

Part No	T Tube O.D. (mm)	L	X	B	F (in)	E	Work. Press. (psig)
PUE-A-M08TSW-SS	8	17.3	14.7	7.9	12.7	6.4	9790
PUE-A-M10TSW-SS	10	19.1	16.5	7.9	14.3	7.4	8100
PUE-A-M12TSW-SS	12	21.3	20.2	9.7	17.5	9.5	6820
PUE-A-M14TSW-SS	14	26.4	23.8	10.0	20.6	10.4	6930
PUE-A-M16TSW-SS	16	26.4	23.8	10.4	20.6	12.7	6190
PUE-A-M20TSW-SS	20	28.7	29.3	11.2	25.4	17.0	5510
PUE-A-M22TSW-SS	22	29.7	31.2	13.5	27.0	19.0	6850
PUE-A-M25TSW-SS	25	31.8	36.7	15.7	31.8	22.0	5450

Male Connector - Pipe Socket Weld X Male Pipe Threads (NPT)

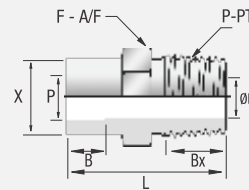

Part No	Px Pipe Size, (NPS)	P Pipe Size, NPT	E Small Bore	B	L	Bx	F	X	Work. Press. (psig)
PMC-04PSW-4N-SS	1/4	1/4	7.1	9.9	35.2	14.2	23.8	22.4	8000
PMC-04PSW-8N-SS	1/4	1/2	9.1	9.9	40.0	19.1	23.8	22.4	7700
PMC-06PSW-6N-SS	3/8	3/8	9.7	9.9	38.0	14.2	27.0	26.2	7100
PMC-06PSW-8N-SS	3/8	1/2	11.9	9.9	42.9	19.1	27.0	26.2	7100
PMC-08PSW-6N-SS	1/2	3/8	9.7	9.9	40.3	14.2	33.3	31.8	6800
PMC-08PSW-8N-SS	1/2	1/2	11.9	9.9	45.2	19.1	33.3	31.8	6800
PMC-12PSW-8N-SS	3/4	1/2	11.9	13.0	54.3	19.1	38.1	37.3	5800
PMC-12PSW-12N-SS	3/4	3/4	15.7	13.0	54.3	19.1	38.1	37.3	5800
PMC-16PSW-12N-SS	1	3/4	15.7	13.0	55.8	19.1	47.6	47.2	6100
PMC-16PSW-16N-SS	1	1	22.4	13.0	60.6	23.9	47.6	47.2	5300

Female Connector - Pipe Socket Weld X Female Pipe Threads (NPT)

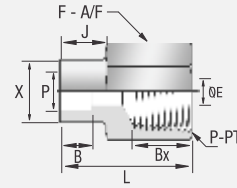

Part No	Px Pipe Size, (NPS)	P Pipe Size, NPT	E Small Bore	B	L	Bx	F	X	Work. Press. (psig)
PFC-4PSW-4N-SS	1/4	1/4	9.1	9.9	33.5	15.0	23.8	22.4	8000
PFC-4PSW-6N-SS	1/4	3/8	9.1	9.9	33.5	15.0	23.8	22.4	6790
PFC-6PSW-6N-SS	3/8	3/8	12.4	9.9	34.1	15.0	27.0	26.2	7100
PFC-6PSW-8N-SS	3/8	1/2	12.4	9.9	39.1	19.8	27.0	26.2	4900
PFC-8PSW-8N-SS	1/2	1/2	15.7	9.9	40.0	19.8	33.3	31.8	6800
PFC-8PSW-12N-SS	1/2	3/4	15.7	9.9	40.6	20.6	33.3	31.8	4600
PFC-12PSW-12N-SS	3/4	3/4	20.8	13.0	53.2	20.6	38.1	37.3	5800
PFC-12PSW-16N-SS	3/4	1	20.8	13.0	58.1	25.4	41.3	37.3	4400

Union - Pipe Socket Weld

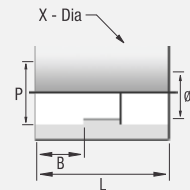

Part No	P Pipe Size (NPS)	E Small Bore	B	L	X	Work. Press. (psig)
PU-4PSW-SS	1/4	9.1	9.9	26.9	22.4	8100
PU-6PSW-SS	3/8	12.4	9.9	28.4	26.2	7100
PU-8PSW-SS	1/2	15.7	9.9	28.4	31.8	6800
PU-12PSW-SS	3/4	20.8	13.0	44.4	37.3	5800
PU-16PSW-SS	1	26.7	13.0	44.4	47.2	6100

Male Connector - Tube Butt Weld (Fractional) X Male Pipe Threads (NPT)

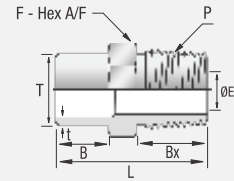

Part No	T Tube O.D. (in.)	t Wall Thickness (in.)	P Pipe Size, NPT	L	B	Bx	F	E	Work. Press. (psig)
PMC-4TBW-4N-SS	1/4	0.065	1/4	29.7	9.7	14.2	14.3	7.1	8000
PMC-4TBW-8N-SS	1/4	0.065	1/2	36.8	9.7	19.1	22.2	11.9	7700
PMC-6TBW-4N-SS	3/8	0.095	1/4	29.7	9.7	14.2	14.3	7.1	8000
PMC-6TBW-8N-SS	3/8	0.095	1/2	36.8	9.7	19.1	22.2	11.9	7700
PMC-8TBW-4N-SS	1/2	0.095	1/4	34.3	14.2	14.2	14.3	7.1	6780
PMC-8TBW-8N-SS	1/2	0.095	1/2	41.1	14.2	19.1	22.2	11.9	6780
PMC-10TBW-4N-SS	5/8	0.109	1/4	34.8	14.2	14.2	17.5	7.1	5760
PMC-10TBW-8N-SS	5/8	0.109	1/2	41.1	14.2	19.1	22.2	11.9	5760
PMC-12TBW-4N-SS	3/4	0.120	1/4	40.1	19.1	14.2	20.6	7.1	5530
PMC-12TBW-8N-SS	3/4	0.120	1/2	46.2	19.1	19.1	22.2	11.9	5530
PMC-16TBW-4N-SS	1	0.134	1/4	42.9	19.1	14.2	27.0	7.1	4480
PMC-16TBW-8N-SS	1	0.134	1/2	47.8	19.1	19.1	27.0	11.9	4480

Male Connector - Tube Butt Weld (Metric) X Male Pipe Threads (NPT)

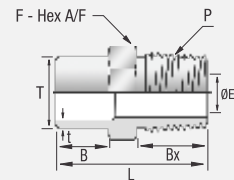

Part No	T Tube O.D. (mm)	t Wall Thickness (in.)	P Pipe Size NPT	L	B	Bx	F	E	Work. Press. (psig)
PMC-M12TBW-4N-SS	12	2.2	1/4	34.3	14.2	14.2	14.0	7.1	6470
PMC-M12TBW-8N-SS	12	2.2	1/2	41.1	14.2	19.1	22.0	11.9	6470
PMC-M14TBW-4N-SS	14	2.5	1/4	34.3	14.2	14.2	15.0	7.1	6280
PMC-M14TBW-8N-SS	14	2.5	1/2	41.1	14.2	19.1	22.0	11.9	6280
PMC-M15TBW-4N-SS	15	2.5	1/4	34.8	14.2	14.2	16.0	7.1	5770
PMC-M16TBW-4N-SS	16	2.8	1/4	35.6	14.2	14.2	18.0	7.1	6140
PMC-M16TBW-8N-SS	16	2.8	1/2	41.1	14.2	19.1	22.0	11.9	6140
PMC-M20TBW-8N-SS	20	3.0	1/2	46.2	19.1	19.1	22.0	11.9	5110
PMC-M22TBW-4N-SS	22	3.0	1/4	41.2	19.1	14.2	24.0	7.1	4620
PMC-M22TBW-8N-SS	22	3.0	1/2	46.1	19.1	19.1	24.0	11.9	4620
PMC-M25TBW-12N-SS	25	3.5	3/4	47.8	19.1	19.1	27.0	15.7	4730
PMC-M25TBW-16N-SS	25	3.5	1	54.9	19.1	23.9	35.0	22.4	4730
PMC-M28TBW-8N-SS	28	4.0	1/2	54.2	21.4	19.1	30.0	11.9	4850

Female Connector - Tube Butt Weld (Fractional) X Female Pipe Threads (NPT)

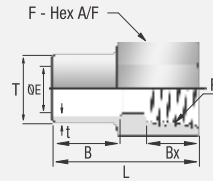
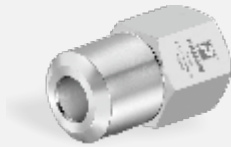

Part No	T Tube O.D. (in.)	t Wall Thickness (in.)	P Pipe Size, NPT	L	B	Bx	F	E	Work. Press. (psig)
PFC-4TBW-4N-SS	1/4	0.065	1/4	27.9	9.7	15.0	19.1	3.0	6600
PFC-4TBW-6N-SS	1/4	0.065	3/8	29.5	9.7	15.0	22.2	3.0	5300
PFC-6TBW-4N-SS	3/8	0.095	1/4	27.9	9.7	15.0	19.1	4.7	6600
PFC-6TBW-6N-SS	3/8	0.095	3/8	29.5	9.7	15.0	22.2	4.7	5300
PFC-8TBW-4N-SS	1/2	0.095	1/4	34.0	14.2	15.0	19.1	7.9	6600
PMC-8TBW-6N-SS	1/2	0.095	3/8	34.0	14.2	15.0	22.2	7.9	5300
PMC-8TBW-8N-SS	1/2	0.095	1/2	38.9	14.2	19.8	27.0	7.9	4900

Female Connector - Tube Butt Weld (Metric) X Female Pipe Threads (NPT)

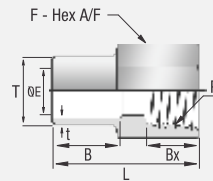

Part No	T Tube O.D. (mm)	t Wall Thickness (in.)	P Pipe Size, NPT	L	B	Bx	F	E	Work. Press. (psig)
PFC-M14TBW-4N-SS	14mm	2.5	1/4	33.0	14.2	15.0	19.0	9.0	6280
PFC-M14TBW-8N-SS	14mm	2.5	1/2	38.9	14.2	19.8	27.0	9.0	4900
PFC-M20TBW-8N-SS	20mm	3.0	1/2	43.7	19.1	19.8	27.0	14.0	4900
PFC-M28TBW-8N-SS	28mm	4.0	1/2	49.8	23.9	19.8	30.0	15.7	4850

Reducing Union - Tube Butt Weld (Fractional)

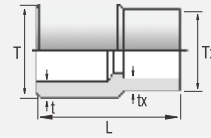

Part No	T.Tube O.D. (in.)	t Wall Thickness (in.)	Tx Tube O.D. (in.)	tx Wall Thickness (in.)	L	Work. Press. (psig)
PRU-6TBW-4TBW-SS	3/8	0.095	1/4	0.065	38.1	9930
PRU-8TBW-4TBW-SS	1/2	0.095	1/4	0.065	38.1	6780
PRU-8TBW-6TBW-SS	1/2	0.095	3/8	0.095	38.1	6780
PRU-12TBW-8TBW-SS	3/4	0.120	1/2	0.095	38.1	5530
PRU-16TBW-4TBW-SS	1	0.134	1/4	0.120	38.1	4480

Reducing Union - Tube Butt Weld (Metric)

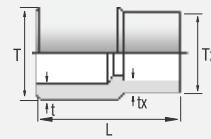

Part No	T.Tube O.D. (mm)	t Wall Thickness (in.)	Tx Tube O.D. (mm.)	tx Wall Thickness (in.)	L	Work. Press. (psig)
PRU-20TBW-14TBW-SS	20	3.0	14	2.5	38.1	6470
PRU-22TBW-14TBW-SS	22	3.0	14	2.5	38.1	5780
PRU-22TBW-18TBW-SS	22	3.0	18	2.8	38.1	5780
PRU-25TBW-22TBW-SS	25	3.5	22	3.0	38.1	5780
PRU-38TBW-25TBW-SS	38	5.0	25	3.5	38.1	5540

Union Elbow - Tube Butt Weld (Fractional)

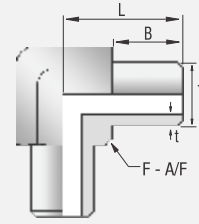

Part No	T Tube O.D. (in.)	t Wall Thickness (in.)	L	B	F	Work. Press. (psig)
PUE-4TBW-SS	1/4	0.065	16.3	9.7	9.5	10320
PUE-6TBW-SS	3/8	0.095	18.0	9.7	11.1	9930
PUE-8TBW-SS	1/2	0.095	24.4	14.2	14.3	6780
PUE-12TBW-SS	3/4	0.120	33.3	19.1	20.6	5530
PUE-16TBW-SS	1	0.134	37.1	19.1	27.0	4480

Union Elbow - Tube Butt Weld (Metric)

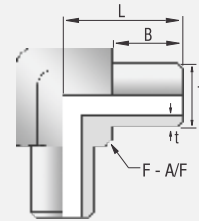

Part No	T Tube O.D. (mm)	t Wall Thickness (in.)	L	B	F	Work. Press. (psig)
PUE-M10TBW-SS	10	2.2	18.0	9.7	11.1	8160
PUE-M14TBW-SS	14	2.5	25.4	14.2	15.9	6280
PUE-M16TBW-SS	16	2.8	26.2	14.2	17.5	6140
PUE-M20TBW-SS	20	3.0	33.3	19.1	20.6	5110
PUE-M22TBW-SS	22	3.0	35.3	19.1	23.8	4620
PUE-M25TBW-SS	25	3.5	37.1	19.1	27.0	4730

Union Tee - Tube Butt Weld (Fractional)

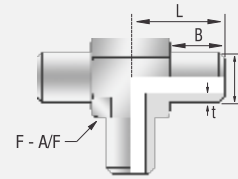
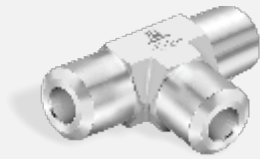

Part No	T Tube O.D. (in.)	t Wall Thickness (in.)	L	B	F	Work. Press. (psig)
PUT-4TBW-SS	1/4	0.065	16.3	9.7	9.5	10320
PUT-6TBW-SS	3/8	0.095	18.0	9.7	11.1	9930
PUT-8TBW-SS	1/2	0.095	24.4	14.2	14.3	6780
PUT-12TBW-SS	3/4	0.120	33.3	19.1	20.6	5530
PUT-16TBW-SS	1	0.134	37.1	19.1	27.0	4480

Union Tee - Tube Butt Weld (Metric)

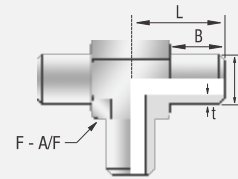
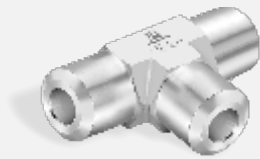

Part No	T Tube O.D. (mm)	t Wall Thickness (in.)	L	B	F	Work. Press. (psig)
PUT-M06TBW-SS	6	1.8	16.3	9.7	9.5	12660
PUT-M08TBW-SS	8	1.8	16.3	9.7	9.5	8320
PUT-M10TBW-SS	10	2.2	18.0	9.7	11.1	8160
PUT-M12TBW-SS	12	2.2	24.4	14.2	14.3	6470
PUT-M14TBW-SS	14	2.5	25.4	14.2	15.9	6280
PUT-M16TBW-SS	16	2.8	26.2	14.2	17.5	6140
PUT-M20TBW-SS	20	3.0	33.3	19.1	20.6	5110
PUT-M22TBW-SS	22	3.0	35.3	19.1	23.8	4620
PUT-M25TBW-SS	25	3.5	37.1	19.1	27.0	4730
PUT-M32TBW-SS	32	4.5	49.3	23.9	34.9	4730

Union Cross - Tube Butt Weld (Fractional)

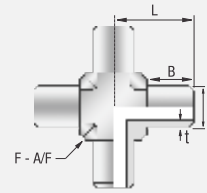

Part No	T Tube O.D. (in.)	t Wall Thickness (in.)	L	B	F	Work. Press. (psig)
PUC-4TBW-SS	1/4	0.065	16.3	9.7	9.5	10320
PUC-6TBW-SS	3/8	0.095	18.0	9.7	11.1	9930
PUC-8TBW-SS	1/2	0.095	24.4	14.2	14.3	6780
PUC-12TBW-SS	3/4	0.120	33.3	19.1	20.6	5530
PUC-16TBW-SS	1	0.134	37.1	19.1	27.0	4480

Union Cross - Tube Butt Weld (Metric)

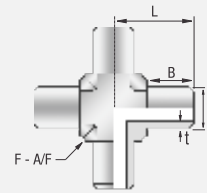

Part No	T Tube O.D. (mm)	t Wall Thickness (in.)	L	B	F	Work. Press. (psig)
PUC-M06TBW-SS	6	1.8	16.3	9.7	9.5	12660
PUC-M08TBW-SS	8	1.8	16.3	9.7	9.5	8320
PUC-M10TBW-SS	10	2.2	18.0	9.7	11.1	8160

Male Connector - Pipe Butt Weld X Male Pipe Threads (NPT)

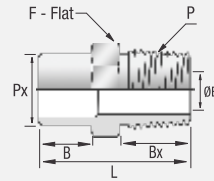

Part No	Px Pipe Size (NPS with Sch80 WT)	P Pipe Size, NPT	L	B	Bx	F	E	Work. Press. (psig)
PMC-4PBW-4N-SS	1/4	1/4	34.3	14.2	14.2	14.3	7.1	8000
PMC-4PBW-8N-SS	1/4	1/2	41.3	14.2	19.1	22.2	7.7	7700
PMC-6PBW-4N-SS	3/8	1/4	34.8	14.2	14.2	17.5	7.1	6650
PMC-6PBW-8N-SS	3/8	1/2	41.3	14.2	19.1	22.2	10.7	6650
PMC-8PBW-4N-SS	1/2	1/4	41.3	19.1	14.2	22.2	7.1	6190
PMC-8PBW-8N-SS	1/2	1/2	46.2	19.1	19.1	22.2	11.9	6190
PMC-12PBW-4N-SS	3/4	1/4	42.9	19.1	14.2	27.0	7.1	5040
PMC-12PBW-8N-SS	3/4	1/2	47.8	19.1	19.1	27.0	11.9	5040
PMC-16PBW-4N-SS	1	1/4	50.0	23.9	14.2	34.9	7.1	4640
PMC-16PBW-8N-SS	1	1/2	54.8	23.9	19.1	34.9	11.9	4640

Female Connector - Pipe Butt Weld X Male Pipe Threads (NPT)

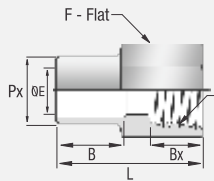
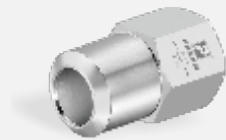

Part No	Px Pipe Size (NPS with Sch80 WT)	P Pipe Size, NPT	L	B	Bx	F	E	Work. Press. (psig)
PFC-4PSW-8N-SS	1/4	1/2	38.9	14.2	19.8	27.0	7.6	4900
PFC-6PSW-8N-SS	3/8	1/2	38.9	14.2	19.8	27.0	10.7	4900
PFC-8PSW-4N-SS	1/2	1/4	37.3	19.1	15.0	22.2	10.4	7500
PFC-8PSW-8N-SS	1/2	1/2	43.7	19.1	19.8	27.0	13.9	4900

Weld Adapter - Tube Socket Weld (Fractional) X Pipe Butt Weld

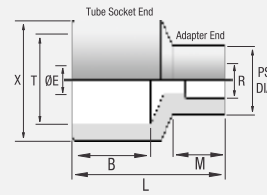

Part No	T Tube O.D. (in.)	P Pipe Size, (NPS)	PS Pipe OD	R Bore	X	M	L	B	E	Work. Press. (psig)
PWA-3TSW-2PBW-SS	3/16	1/8	10.41	5.33	11.18	9.65	19.81	5.08	3.56	8700
PWA-4TSW-2PBW-SS	1/4	1/8	10.41	5.33	12.70	9.65	21.34	6.35	4.83	8700
PWA-5TSW-2PBW-SS	5/16	1/8	10.41	5.33	14.99	9.65	23.62	7.87	5.33	8700
PWA-6TSW-4PBW-SS	3/8	1/4	13.72	7.62	16.00	14.22	28.45	8.64	7.62	8100
PWA-8TSW-4PBW-SS	1/2	1/4	13.72	7.62	19.81	14.22	31.24	10.41	7.62	8100
PWA-8TSW-6PBW-SS	1/2	3/8	17.27	10.67	19.81	14.22	30.23	10.41	10.41	6900
PWA-10TSW-8PBW-SS	5/8	1/2	21.34	13.97	23.68	19.05	36.32	11.94	12.70	4900
PWA-12TSW-4PBW-SS	3/4	1/4	13.72	7.62	27.69	14.22	35.81	12.70	7.62	6000
PWA-12TSW-6PBW-SS	3/4	3/8	17.27	10.67	27.69	14.22	34.80	12.70	10.67	6000
PWA-12TSW-8PBW-SS	3/4	1/2	21.34	13.97	27.69	19.05	38.35	12.70	13.97	6000
PWA-12TSW-12PBW-SS	3/4	3/4	26.67	18.54	27.69	19.05	36.83	12.70	16.76	5300
PWA-16TSW-4PBW-SS	1	1/4	13.72	7.62	36.58	14.22	39.88	14.22	7.62	4900
PWA-16TSW-6PBW-SS	1	3/8	17.27	10.67	36.58	14.22	38.86	14.22	10.67	4900
PWA-16TSW-8PBW-SS	1	1/2	21.34	13.97	36.58	19.05	42.42	14.22	13.97	4900
PWA-16TSW-12PBW-SS	1	3/4	26.67	18.54	36.58	19.05	40.89	14.22	18.54	4900
PWA-16TSW-16PBW-SS	1	1	33.27	24.13	36.58	23.88	43.69	14.22	23.11	4900
PWA-24TSW-24PBW-SS	1-1/2	1-1/2	48.26	38.10	50.80	26.16	48.77	17.02	33.27	3700
PWA-32TSW-32PBW-SS	2	2	60.45	49.28	66.80	26.92	53.34	19.81	45.97	3200

Adaptor - Tube Socket Weld (Fractional) X Pipe Butt Weld

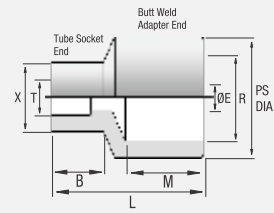

Part No	T Tube O.D. (in.)	P Pipe Size, (NPS)	PS Pipe OD	R Bore	X	L	D	B	E Bore	Work. Press. (psig)
PWA-2TSW-2PBW-SS	1/8	1/8	10.41	5.33	9.65	9.65	18.54	4.06	2.29	8700
PWA-2TSW-4PBW-SS	1/8	1/4	13.72	7.62	9.65	14.22	24.13	4.06	2.29	8200
PWA-3TSW-8PBW-SS	3/16	1/2	21.34	13.97	11.18	19.05	32.00	5.08	3.56	6400
PWA-3TSW-12PBW-SS	3/16	3/4	26.67	18.54	11.18	19.05	33.53	5.08	3.56	5300
PWA-4TSW-4PBW-SS	1/4	1/4	13.72	7.62	12.70	14.22	25.65	6.35	4.83	8200
PWA-4TSW-6PBW-SS	1/4	3/8	17.27	10.67	12.70	14.22	26.67	6.35	4.83	6900
PWA-4TSW-8PBW-SS	1/4	1/2	21.34	13.97	12.70	19.05	32.77	6.35	4.83	6400
PWA-4TSW-12PBW-SS	1/4	3/4	26.67	18.54	12.70	19.05	34.29	6.35	4.83	5300
PWA-4TSW-16PBW-SS	1/4	1	33.27	24.13	12.70	23.88	40.89	6.35	4.83	4900
PWA-5TSW-8PBW-SS	5/16	1/2	21.34	13.97	14.99	19.05	33.53	7.87	6.35	6400
PWA-6TSW-6PBW-SS	3/8	3/8	17.27	10.67	16.00	14.22	28.19	8.64	7.87	6900
PWA-6TSW-8PBW-SS	3/8	1/2	21.34	13.97	16.00	19.05	34.04	8.64	7.87	6400
PWA-6TSW-12PBW-SS	3/8	3/4	26.67	18.54	16.00	19.05	35.56	8.64	7.87	5300
PWA-6TSW-16PBW-SS	3/8	1	33.27	24.13	16.00	23.88	42.42	8.64	7.87	4900
PWA-6TSW-24PBW-SS	3/8	1-1/2	48.26	38.10	16.00	26.16	49.02	8.64	7.87	3700
PWA-8TSW-8PBW-SS	1/2	1/2	21.34	13.97	19.81	19.05	34.54	10.41	11.18	6400
PWA-8TSW-12PBW-SS	1/2	3/4	26.67	18.54	19.81	19.05	36.07	10.41	11.18	5300
PWA-8TSW-16PBW-SS	1/2	1	33.27	24.13	19.81	23.88	42.93	10.41	11.18	4900
PWA-10TSW-12PBW-SS	5/8	3/4	26.67	18.54	23.88	19.05	36.58	11.94	12.70	5300
PWA-10TSW-16PBW-SS	5/8	1	33.27	24.13	23.88	23.88	43.18	11.94	12.70	4900
PWA-12TSW-16PBW-SS	3/4	1	33.27	24.13	27.69	23.88	42.93	12.70	16.76	4900
PWA-16TSW-20PBW-SS	1	1-1/4	42.16	32.51	36.58	23.88	44.45	14.22	23.11	4100
PWA-16TSW-24PBW-SS	1	1-1/2	48.26	38.10	36.58	26.16	48.51	14.22	23.11	3700
PWA-20TSW-20PBW-SS	1-1/4	1-1/4	42.16	32.51	44.45	23.88	45.21	16.00	26.92	4100
PWA-20TSW-24PBW-SS	1-1/4	1-1/2	48.26	38.10	44.45	26.16	48.01	16.00	26.92	3700

Pipe to Tube Butt Weld - Female ISO Parallel / BSPP PipeThreads X Tube Butt Weld (Metric)

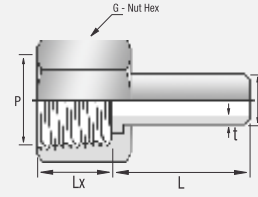
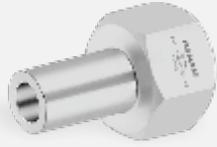

Part No	P. Thread Size (in.)	T Tube OD (mm)	t Wall thicknes	L	G	Lx	Work. Press. (psig)
PFC-TH-8G-M12TBW-SS	1/2	12	2.2	34.0	27.0	11.0	6470
PFC-TH-8G-M14TBW-SS	1/2	14	2.5	34.0	27.0	11.0	6820
PFC-TH-8G-M16TBW-SS	1/2	18	2.8	34.0	27.0	11.0	6140

Pipe to Tube Butt Weld - Female Metric Pipe Thread X Tube Butt Weld (Metric)

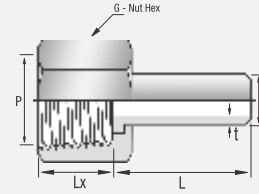
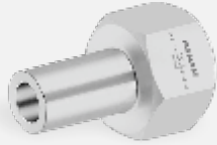

Part No	P. Metric Thread Size	T Tube OD	t Wall thickness	L	G	Lx	Work. Press. (psig)
PFC-TH-M12X1.5M06TBW-SS	M12 X 1.5	6	1.8	25.0	16.0	9.0	12660
PFC-TH-M12X1.5M08TBW-SS	M12 X 1.5	8	1.8	30.0	16.0	9.0	8320
PFC-TH-M14X1.5M08TBW-SS	M14 X 1.5	8	1.8	30.0	18.0	9.0	8320
PFC-TH-M14X1.5M10TBW-SS	M14 X 1.5	10	2.2	30.0	18.0	9.0	8160
PFC-TH-M16X1.5M08TBW-SS	M16 X 1.5	8	1.8	30.0	22.0	9.0	8320
PFC-TH-M16X1.5M10TBW-SS	M16 S 1.5	10	2.2	30.0	22.0	9.0	8160
PFC-TH-M16X1.5M12TBW-SS	M16 X 1.5	12	2.2	34.0	22.0	9.0	6470
PFC-TH-M18X1.5M10TBW-SS	M18 X 1.5	10	2.2	34.0	22.0	10.0	8160
PFC-TH-M18X1.5M12TBW-SS	M18 X 1.5	12	2.2	34.0	22.0	10.0	6470
PFC-TH-M18X1.5M14TBW-SS	M18 X 1.5	14	2.5	34.0	22.0	10.0	6280
PFC-TH-M20X1.5M10TBW-SS	M20 X 1.5	10	2.2	34.0	25.0	11.0	8160
PFC-TH-M20X1.5M12TBW-SS	M20 x 1.5	12	2.2	34.0	25.0	11.0	6470
PFC-TH-M20X1.5M14TBW-SS	M20 X 1.5	14	2.5	34.0	25.0	11.0	6280
PFC-TH-M20X1.5M15TBW-SS	M20 X 1.5	15	2.5	34.0	25.0	11.0	6160
PFC-TH-M20X1.5M16TBW-SS	M20 X 1.5	16	2.8	34.0	25.0	11.0	6140
PFC-TH-M22X1.5M14TBW-SS	M22 X 1.5	14	2.5	34.0	27.0	11.0	6280
PFC-TH-M22X1.5M16TBW-SS	M22 X 1.5	16	2.8	34.0	27.0	11.0	6140
PFC-TH-M24X1.5M16TBW-SS	M24 X 1.5	16	2.8	34.0	30.0	11.0	6140
PFC-TH-M24X1.5M18TBW-SS	M24 X 1.5	18	2.8	34.0	30.0	11.0	5670
PFC-TH-M24X1.5M20TBW-SS	M24 X 1.5	20	3.0	34.0	30.0	11.0	5110
PFC-TH-M27X1.5M14TBW-SS	M27 X 2	14	2.5	34.0	32.0	14.0	6280
PFC-TH-M27X1.5M16TBW-SS	M27 X 2	16	2.8	34.0	32.0	14.0	6140
PFC-TH-M27X1.5M18TBW-SS	M27 X 2	18	2.8	34.0	32.0	14.0	5670
PFC-TH-M27X1.5M20TBW-SS	M27 X 2	20	3.0	40.0	32.0	14.0	5110
PFC-TH-M27X1.5M22TBW-SS	M27 X 2	22	3.0	40.0	32.0	14.0	4620
PFC-TH-M30X1.5M22TBW-SS	M30 X 2	22	3.0	40.0	35.0	18.0	4620
PFC-TH-M30X1.5M25TBW-SS	M30 X 2	25	3.5	45.0	35.0	18.0	4730
PFC-TH-M33X1.5M28TBW-SS	M33 X 2	28	4.0	45.0	41.0	18.0	5160
PFC-TH-M36X1.5M30TBW-SS	M36 X 2	30	4.0	45.0	41.0	18.0	4760

Male Pipe to Tube Butt Weld - Male NPT Pipe X Tube Butt Weld (Metric)

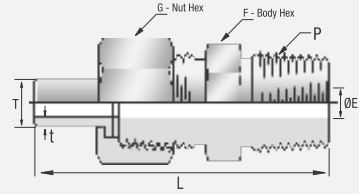

Part No	P - NPT Pipe Threads Size	T Tube O.D	t Wall Thickness	L	F	G	E	Work. Press. (psig)
PMC-TH-2N-M14TBW-SS	1/8	14	2.5	69.0	19.0	22.0	4.8	6280
PMC-TH-4N-M06TBW-SS	1/4	6	1.8	60.0	14.0	14.0	3.0	8240
PMC-TH-4N-M08TBW-SS	1/4	8	1.8	73.2	14.0	16.0	4.0	8240
PMC-TH-4N-M10TBW-SS	1/4	10	2.2	73.2	15.0	18.0	6.0	8160
PMC-TH-4N-M12TBW-SS	1/4	12	2.2	73.2	18.0	22.0	7.0	6470
PMC-TH-4N-M14TBW-SS	1/4	14	2.5	73.2	19.0	22.0	7.1	6280
PMC-TH-4N-M16TBW-SS	1/4	16	2.8	73.2	22.0	25.0	7.1	6140
PMC-TH-4N-M18TBW-SS	1/4	18	2.8	74.2	24.0	27.0	7.1	5670
PMC-TH-6N-M14TBW-SS	3/8	14	2.5	73.2	19.0	22.0	9.7	6280
PMC-TH-8N-M12TBW-SS	1/2	12	2.2	78.0	18.0	22.0	7.0	6470
PMC-TH-8N-M14TBW-SS	1/2	14	2.5	78.0	19.0	22.0	9.0	6280
PMC-TH-8N-M16TBW-SS	1/2	16	2.8	78.0	22.0	25.0	10.0	6140
PMC-TH-8N-M22TBW-SS	1/2	22	3.0	82.0	30.0	32.0	11.9	4620
PMC-TH-8N-M25TBW-SS	1/2	25	2.8	86.0	32.0	35.0	11.9	4730
PMC-TH-16N-M25TBW-SS	1	25	3.5	103.0	35.0	35.0	17.0	4730

Other Products



Valve Manifolds & Gauge Root Valves



Needle Valves



Ball Valves & Check Valves



Relief Valves



Filters



Tube Fittings



Pipe Fittings



37° JIC Fittings (Flare Fittings)



Thermowells



Pressure, Temperature & Diaphragm Gauges



Pressure Transmitters



Pressure Regulators



Double Block & Bleed Valves



Air Header & Condensate Pots



Industrial Valves



PANAM ENGINEERS LTD.

An ISO 9001:2008 Company

203, Jaisingh Business Center, Parsiwada, Sahar Road, Andheri (East), Mumbai - 400 099. INDIA
Tel.: +91 22 2831 5555 / 57 / 58 • Fax: +91 22 2831 5574 • email: sales@panamengineers.com / sales@panam.in
website: www.panamengineers.com / www.panam.in